

# Les TAMARIS

35 220 CHATEAUBOURG

Maître d'oeuvre  
**RHIZOME**  
 AGENCE D'ARCHITECTURE ET D'URBANISME  
 RHIZOME  
 18 avenue du bois labbé - 35000 RENNES  
 Tél: 02.99.27.76.33 - www.agence-rhizome.fr

Maître d'ouvrage  
 SCCV "LES OCEANIDES"  
 49, mail François Mitterrand - 35000 RENNES  
 Tél: 02.99.85.99.03 - www.cap-accession.fr

Maître d'ouvrage délégué  
  
**PROMOTEUR COOPÉRATIF**  
 49, mail François Mitterrand - 35000 RENNES  
 Tél: 02.99.85.99.03 - www.cap-accession.fr

**B105** **T4 (duplex)**

DESIGNATION	SURFACES HABITABLES
<b>R+1</b>	
ENTREE / DGT.	5.55
CELLIER	4.20
SEJOUR / CUISINE	32.95
WC	1.20
<b>R+2</b>	
DGT	5.35
WC	1.70
CHAMBRE 1 + PL.	11.30
CHAMBRE 2	10.00
CHAMBRE 3 + PL.	9.40
SDB	4.85
<b>TOTAL</b>	<b>86.50</b>
TERRASSE	6.95

APPARTEMENT  
**B105**

**R+1 / R+2**

Le: 07 Juillet 2022  
 Echelle: 1/75

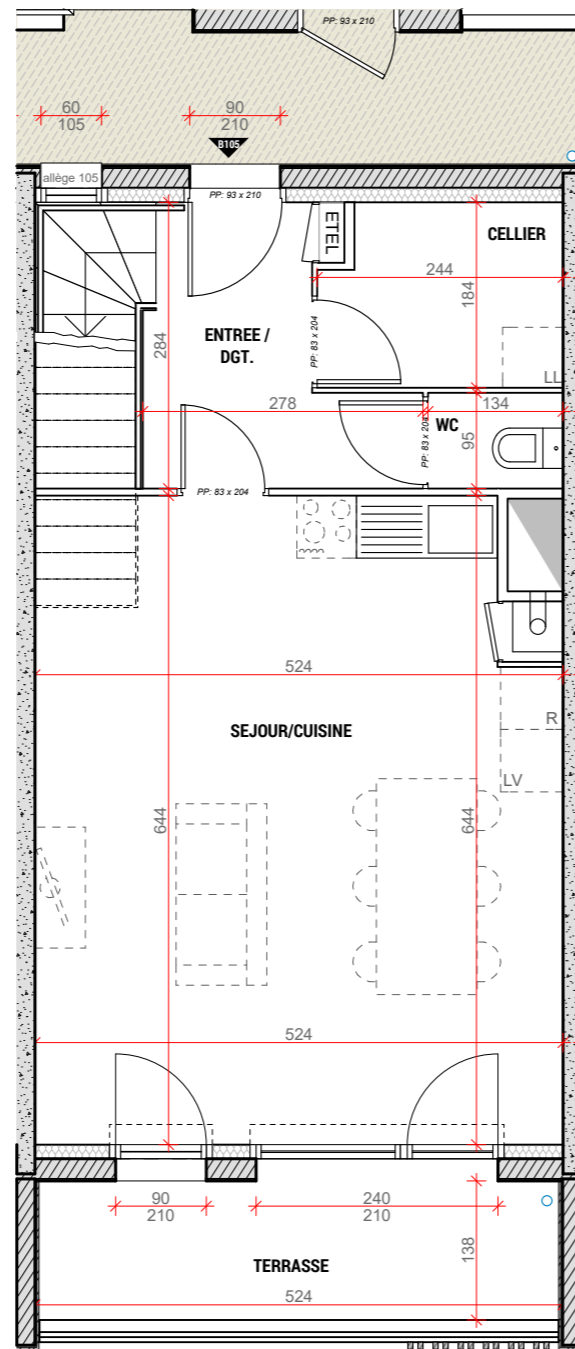

**R+1**

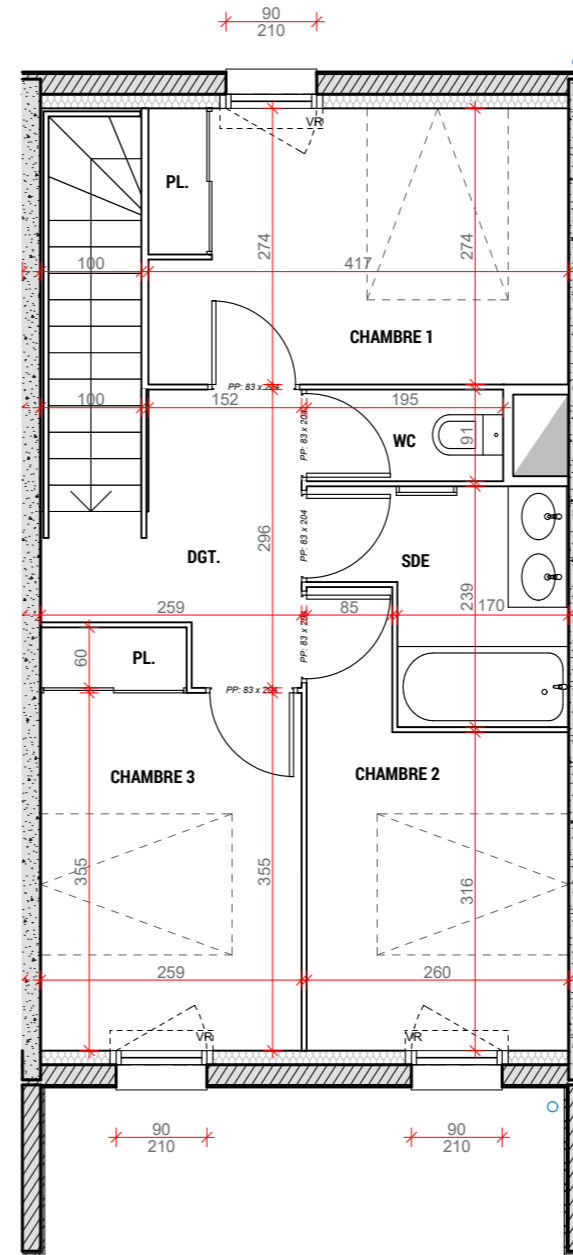





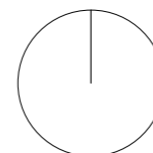

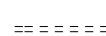

**R+2**

**Nord**

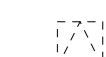
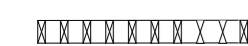
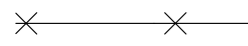

**LEGENDE:**  
 - VRE : VOLET ROULANT ELECTRIQUE  
 - VR : VOLET ROULANT  
 - OB : OSCILLO BATTANT

-  ESPACE TECHNIQUE ELECTRIQUE DU LOGEMENT
-  SOFFITE
-  CLOISON DÉMONTABLE
-  RETOMBÉE DE POUTRE (Suivant étude BA)  
ou RETOMBÉE DE BALCON
-  TRAPPE ACCES VMC
-  PARE-VUE BOIS (HT min 2.50m)
-  CLÔTURE
-  TALUS
-  GRAVIERS
-  HAIE

NOTA: Des modifications mineures ou des aménagements de détails nécessaires pour des raisons d'ordre technique ou administratif pourront être apportés aux plans.

LOCALISATION R+1 / R+2

